

VERONICA  
OTTOMAN BED

Note:  
 \*Read instructions carefully.  
 \*Carefully identify each component especially those that are similar.  
 \*Separate and identify each component from the hardware pack and rest each one in its proper location before fastening.  
 \*Do not over tighten the screws or bolts when assembling.

2 Persons

TOOL REQUIRED

Step 1

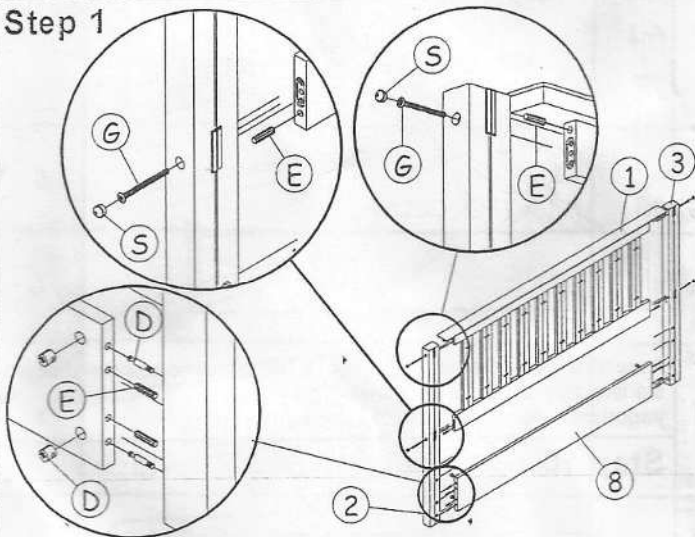

Fix all headboard component as shown

Step 2

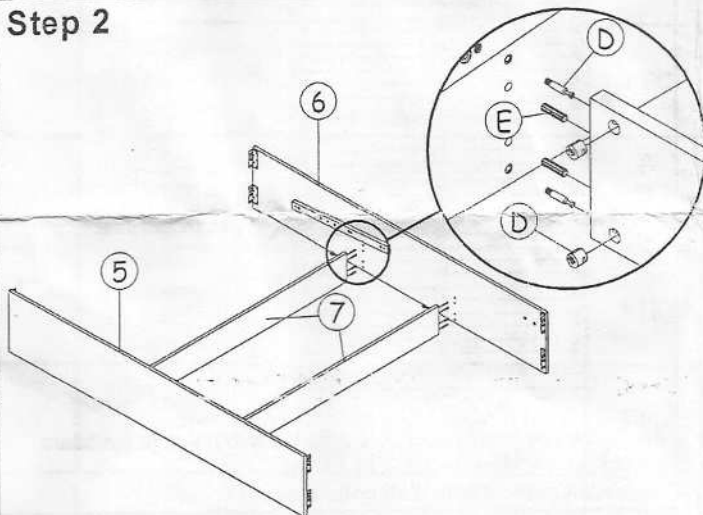

Assemble the left & right side rails to the center storage panel with minifix screws as shown.

Step 3

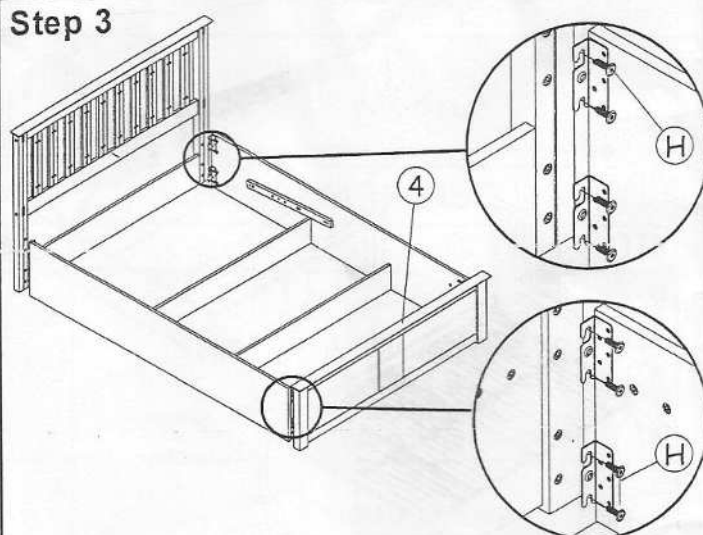

Fix side rails to the headboard and footboard '4' with bolts 'H' as shown.

Step 4

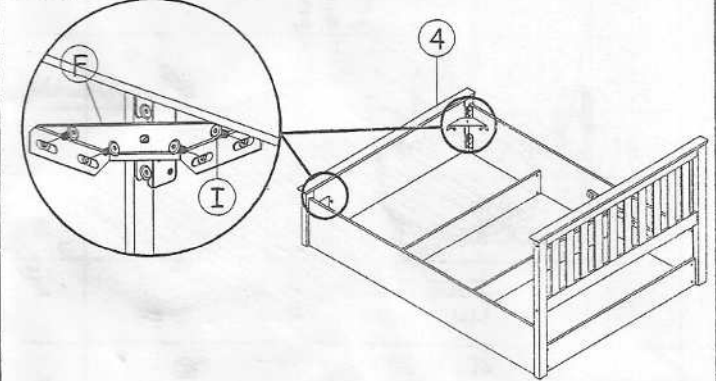

Fix metal corner block 'F' to the edge of footboard and side rails with bolts 'I' as shown.

Step 5

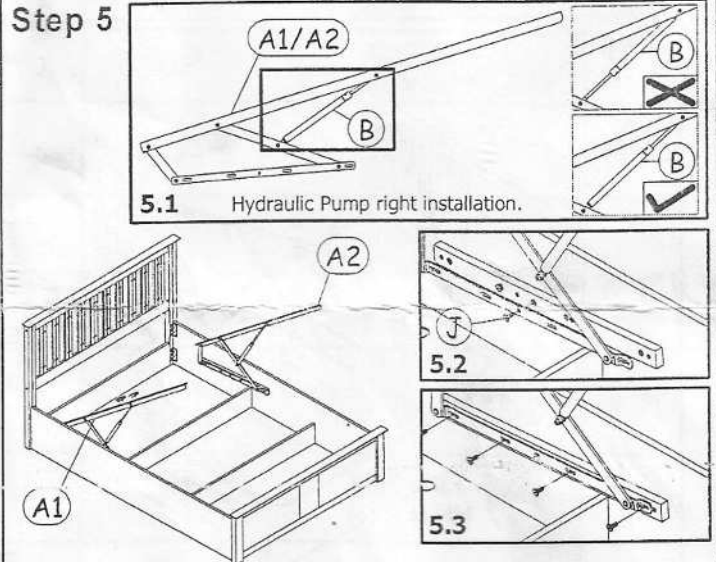

Firstly, fix the hydraulic pump to each hydraulic base as shown in diagram 5.1. Next, fix the left & right hydraulic support to the both side rails. Then, fix bolts 'J' first as shown in diagram 5.2 and do not tighten yet. Finally, fix all bolts and tighten as shown in diagram 5.3.

Step 6

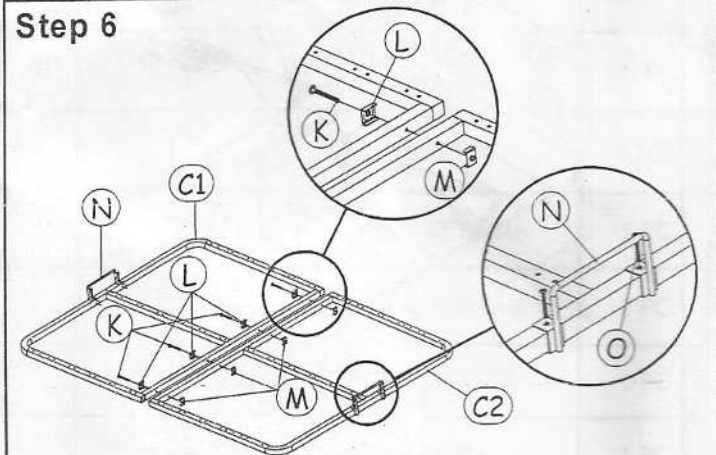

Assemble front & back frames bed base with bolts 'K' and fix base handles to the bed base with bolts 'O' as shown.

Please follow our assembly instruction procedure for easier assemble.

### Step 7

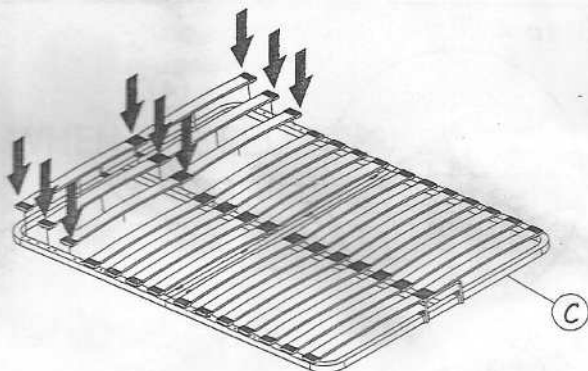
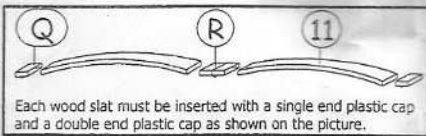

Place wood slats with plastic caps as above drawing. Then, fix it on the bed base by pressing it accordingly to the default holes. Ensure the plastic cap's pin is aimed to the hole.

### Step 8

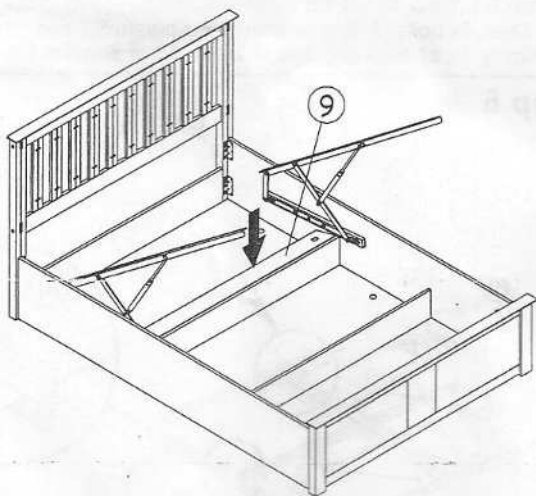
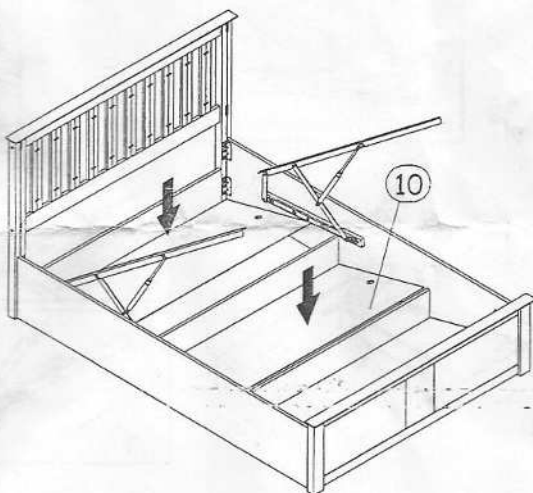

Place bottom base panels '9' & '10' as shown.

### Step 9

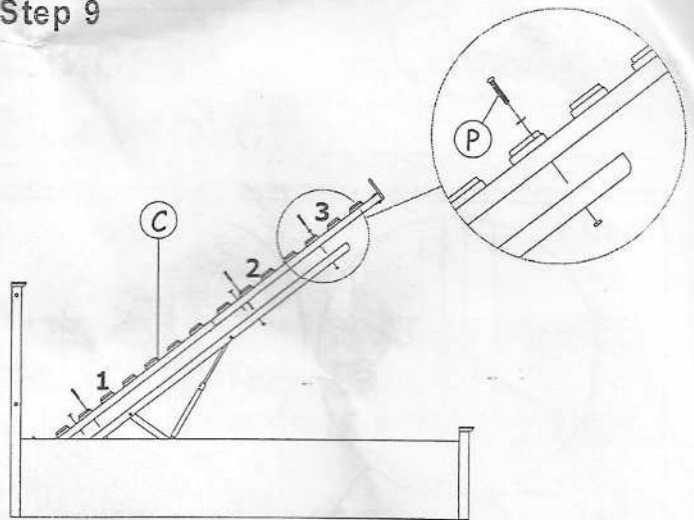

Assemble the bed base on the right & left hydraulic frame and fix bolts starting from '1' to '3' as shown.  
Important note : Do not tighten the bolts yet!

### Step 10

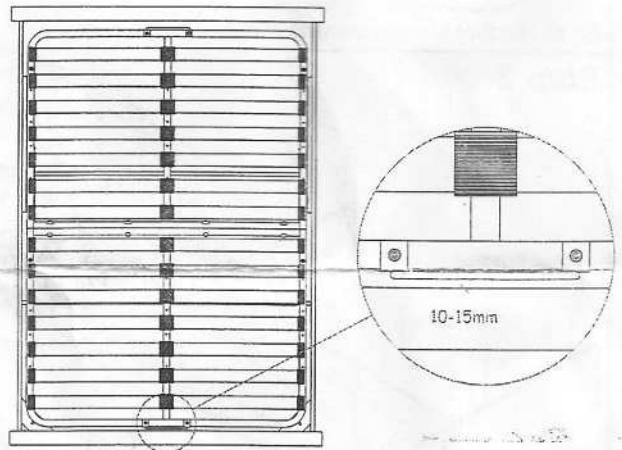

Adjust the bed base, make sure distance with the front footboard approximately 10 -15mm gap as shown.  
Important note : Tighten all bolts & screws.

### THE BED HAS BEEN FULLY ASSEMBLED

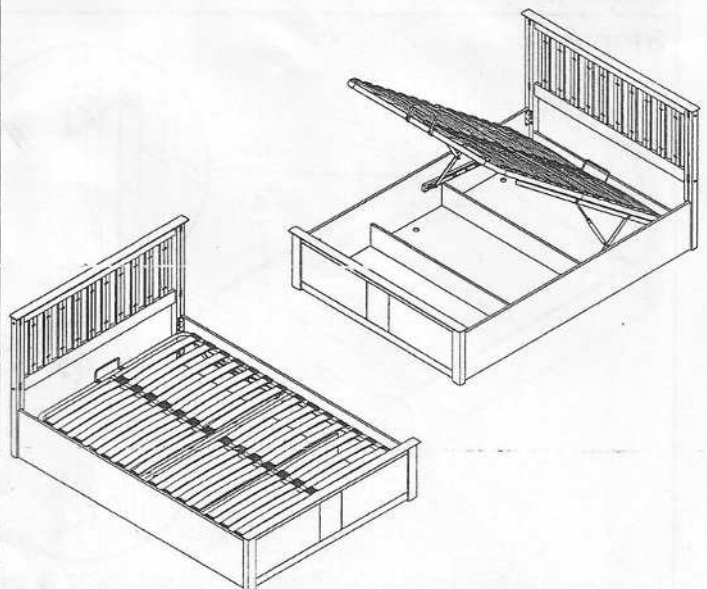

Please follow our assembly instruction procedure for easier assemble.

# HARDWARE & PART LIST OTO-45-6868-WSR-BW-76"

PART LIST			NO.	ITEM	QTY.
1	 HEADBOARD FRAME	1 PC	C	1. BED BASE (B) (1 x HOLE MOUNTING)  2. BED BASE (F) (2 x HOLE MOUNTING)	1 PC  1 PC
2	 WOOD POST (L)	1 PC	D	 MINI FIX	12 PCS
3	 WOOD POST (R)	1 PC	E	 WOOD DOWEL 8 x 30	16 PCS
4	 FOOTBOARD	1 PC	F	 ML-CB (METAL CORNER BLOCK)	2 PCS
5	 SIDE RAIL (L)	1 PC	G	 JCBC BOLT M6 x 70MM	4 PCS
6	 SIDE RAIL (R)	1 PC	H	 JCBC BOLT M8 x 25MM	16 PCS
7	 CENTER STORAGE PANEL	2 PCS	I	 JCBC BOLT M8 x 15MM	8 PCS
8	 BACK STORAGE PANEL	1 PC	J	 JCBC BOLT M8 x 20MM	10 PCS
9	 SMALL BASE PANEL	1 PC	K	 JCBC BOLT M8 x 75MM	4 PCS
10	 BIG BASE PANEL	3 PCS	L	 FLAT WASHER M8	4 PCS
11	 WOOD SLAT	28 PCS	M	 BASE NUT	4 PCS
<b>HARDWARE LIST</b>			N	 BASE HANDLE	2 PCS
A	 1. HYDRAULIC BASE SUPPORT (L) 2. HYDRAULIC BASE SUPPORT (R)	1 PC 1 PC	O	 TCRC BOLT M6 x 40MM	4 PCS
B	 HYDRAULIC PUMP	2 PCS	P	 M8 x 40MM RH BOLT c/w HEX NUT, SPRING & FLAT WASHER	6 PCS
			Q	 SINGLE END PLASTIC CAP	28 PCS
			R	 DOUBLE SIDE END PLASTIC END	14 PCS
			S	 WOOD BUTTON	4 PCS
				 ALLEN KEY - M6	1 PC
				 ALLEN KEY - M8	1 PC
				 M12.8 SPANAR	1 PC
				 M14 SPANAR	1 PC

\*CAUTION : KEEP ALL HARDWARE PARTS OUT OF REACH OF CHILDREN\*

**Please follow our assembly instruction procedure for easier assemble.**

## " IMPORTANT NOTE "

WHEN THE BED IS BUILT AND THE MATTRESS FRAME IS AT 45 DEGREE  
PLEASE PLACE THE MATTRESS ON THE BED.

PLEASE NOTE THAT THE WEIGHT OF THE MATTRESS IS REQUIRED TO  
HELP CLOSE THE BED.

TO LOWER THE SLEEPING PLATFORM STAND AT THE FOOT END OF THE  
BED AND PUSH SHARPLY  
DOWNWARDS USING BOTH HANDS.

